

NOTICE OF HEARING
WILDLIFE AND COUNTRYSIDE ACT 1981 SECTION
53

Notice is hereby given that an Inspector will be appointed by
the Secretary of State for Environment, Food and Rural Affairs to determine

Essex County Council
Definitive Map Modification No. 617
Footpath 59 Nazeing (Epping Forest District) Order 2016

and will attend at:

**The offices of Epping Forest District Council, Civic Centre,
High Street, Epping CM16 4BZ**

On Tuesday 4 April 2017 at 10.00am

To hold a hearing into the Order

The effect of the Order, if confirmed without modifications, will be to modify the Definitive Map for the area by:-

1. Adding a length of Footpath 59 Nazeing, from Waltham Road (Nazeing Long Green) at the western boundary of the property known as "Selways" in a north-north-westerly direction for a distance of 70 metres then turning north-east for a distance of 55 metres to join the unaffected part of the route. The width of the added section is four feet (1.22 metres)
2. Deleting a length of Footpath 59 Nazeing from a point D on the order plan in a south-south-easterly direction for a distance of 70 metres to meet Waltham Road at Point A.

Any person wishing to view the statements of case and other documents relating to this Order may do so by appointment at the Offices of Essex Legal Services, Seax House, Victoria Road South, Chelmsford CM1 1QH Monday to Friday between 9:30am and 5:00pm. Telephone: 0333 013 9679.

Planning Inspectorate Reference: FPS/Z1585/7/86
Contact point at the Planning Inspectorate: Jean McEntee, Rights of Way
Section, Room 3/G, Hawk Wing, Temple Quay House, 2 The Square, Temple
Quay, Bristol BS1 6PN.

Tel: 0303 444 5437 Email: jean.mcentee@pins.gsi.gov.uk

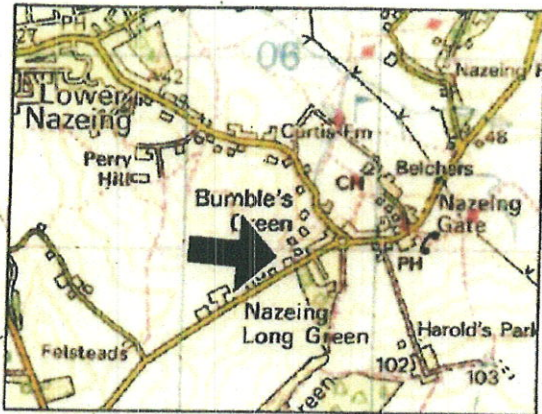

Key

Footpath 59 Nazeing

Delete Route A - D

Add Route G - B - H - D

Unaffected Route

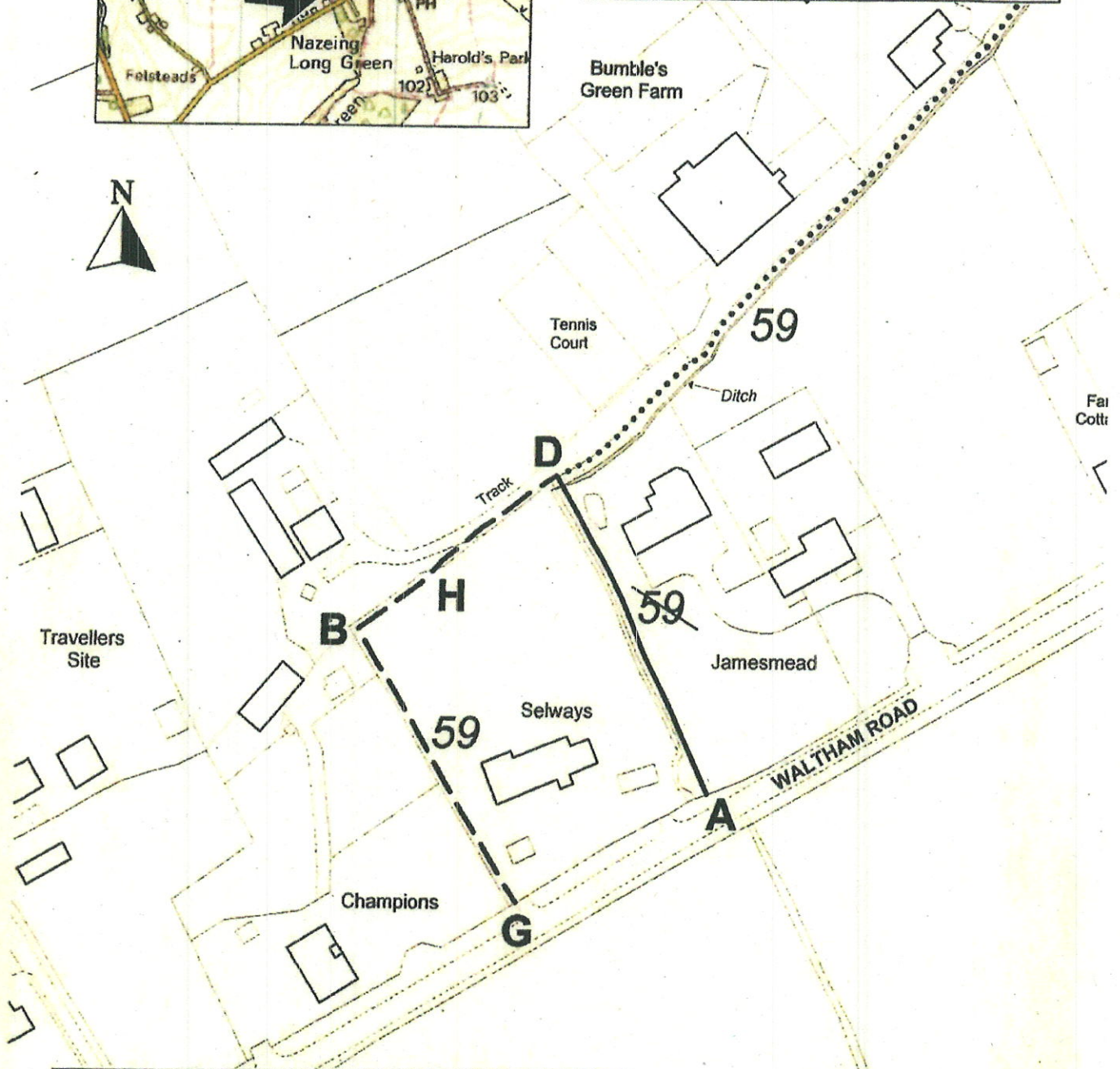

The Essex County Council Definitive Map Modification No. 617 (Footpath 59 Nazeing, Epping Forest District) Order 2016

Definitive Map Sheet TL40SW Scale 1:1250
Grid Ref TL406,049 or 5406,2049

Essex County Council

© Crown copyright and database rights
Ordnance Survey Licence No. 100019602